

2 bedroom house for sale in Gweru (Zimbabwe)



\$22,000



Nehosho Housing Scheme Core House



Solomon Tanyanyiwa +263 7 733 39988
solomon.tanyanyiwa@pamgolding.co.zw

Harare Borrowdale +263 (24) 288 6995-7/288 5999
E & OE



2 bedroom house for sale in Gweru (Zimbabwe)



\$22,000



Pam Golding Properties presents a choice of two 4 roomed units in CBZ's Nehosho housing project in Gweru. The floor plan of the house sits on 50m², with a stand size of 220m² leaving plenty of room to extension. The project is located 13km from Gweru city centre and 3km from Midlands State University, making it an investors dream. Call Solomon today to arrange a viewing.



Erf Size: 400 m²
Building / Unit size: 50 m²

Features

2 bedrooms / 1 bathroom / 1 reception room / water / electricity / family/tv room

Energy Supplies: Eskom

Harare Borrowdale +263 (24) 288 6995-7/288 5999
E & OE



2 bedroom house for sale in Gweru (Zimbabwe)



\$22,000

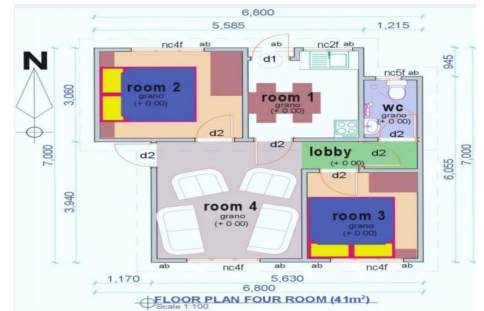

Ref#: 3ZB1540371



Harare Borrowdale +263 (24) 288 6995-7/288 5999
E & OE

